

**TECHNICAL GUIDE  
&  
PARTS CATALOGUE**

**Cal.VH6 Series  
(VH60A/61A/63A/64A/65A/67A/68A)**

**ANALOGUE QUARTZ**

	Cal. No.	VH63A						
Movement		<p style="text-align: center; font-weight: bold;">*Refer to the pages 2 for other Cal. No. specifications.</p>						
Movement size	Outside diameter	$\phi 23.70$ mm 22.60 mm : between 12 o'clock and 6 o'clock sides 22.60 mm : between 3 o'clock and 9 o'clock sides						
	Casing diameter	$\phi 23.30$ mm 22.10 mm : between 12 o'clock and 6 o'clock sides 21.40 mm : between 3 o'clock and 9 o'clock sides						
	Total height	3.45 mm						
Time indication	Cal. No.	VH60A	VH61A	VH63A	VH64A	VH65A	VH67A	VH68A
	3 Hands (hour, minute, second)	○	○	○	○	○	○	○
	24 Hour hand (6H)	○	○	○	—	—	○	○
	Date Calendar Hand (3H)	—	—	○	○	○	—	—
	Date Calendar Hand (2H)	—	—	—	—	—	—	○
	Date Calendar Hand (12H)	—	○	—	—	—	○	—
	Day Calendar Hand (9H)	—	—	○	○	—	○	—
	Day Calendar Hand (10H)	—	—	—	—	—	—	○
Driving system	Step motor							
Additional mechanism	Electronic circuit reset switch Second setting device							
Antimagnetic	$\geq 1600$ A/m							
Accuracy	Less than $\pm 15$ seconds : Monthly rate at normal temperature range							
Battery	SR920SW (Silver oxide battery) Battery life is approximately 2 years							
Measuring gate by quartz tester	Use 10 second gate * Set the winding stem with crown at the normal position							
Jewels	2 Jewels							

**VH60A**



**VH61A**



**VH63A**

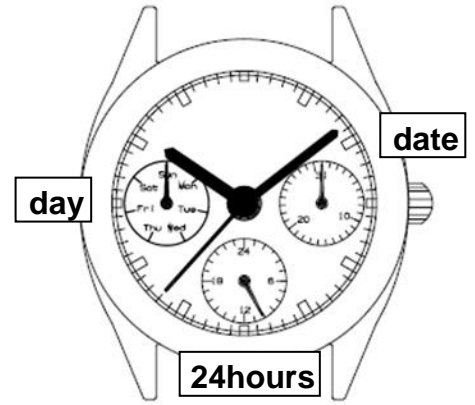

**VH64A**

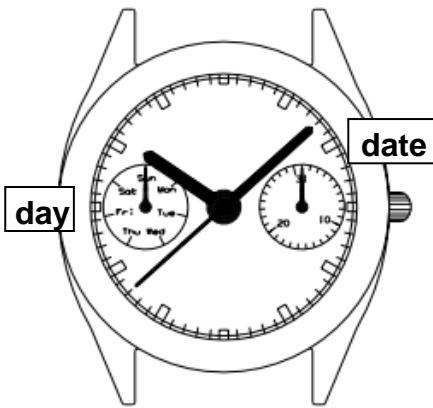

**VH65A**

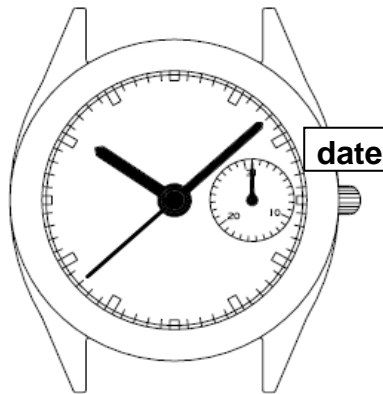



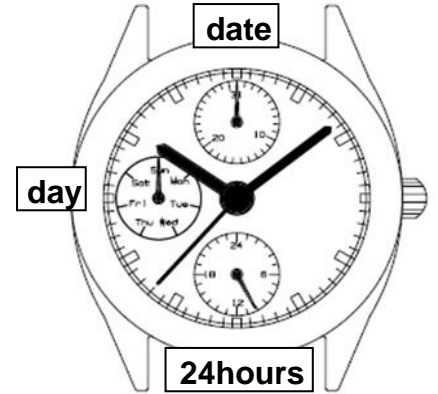

**VH67A**

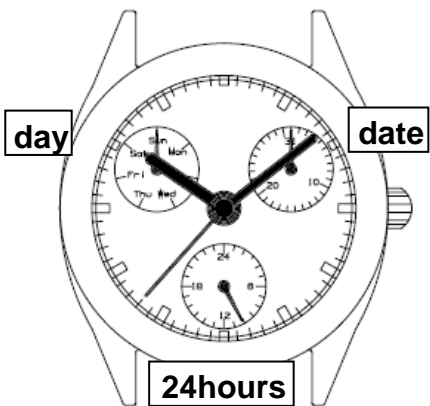

**VH68A**

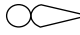

Disassembling procedures Figs. ① → ④⑥	Lubricating : Types of oil	
		A3a / Moebius 9010
Reassembling procedures Figs. ④⑥ → ①		A2a / Moebius 9030
	Oil quantity	 Normal quantity
		Sufficient quantity

## <<VH60A>>

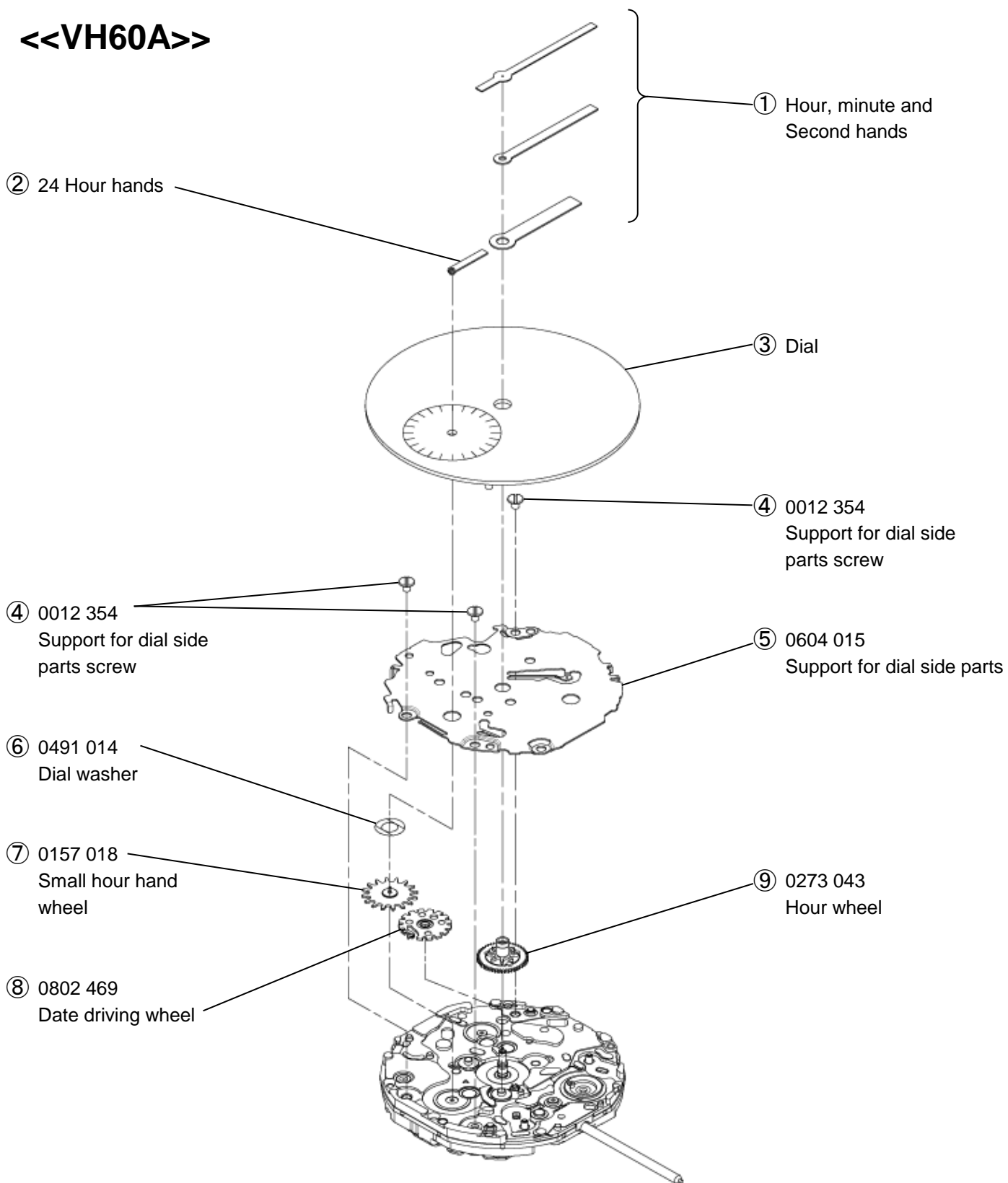

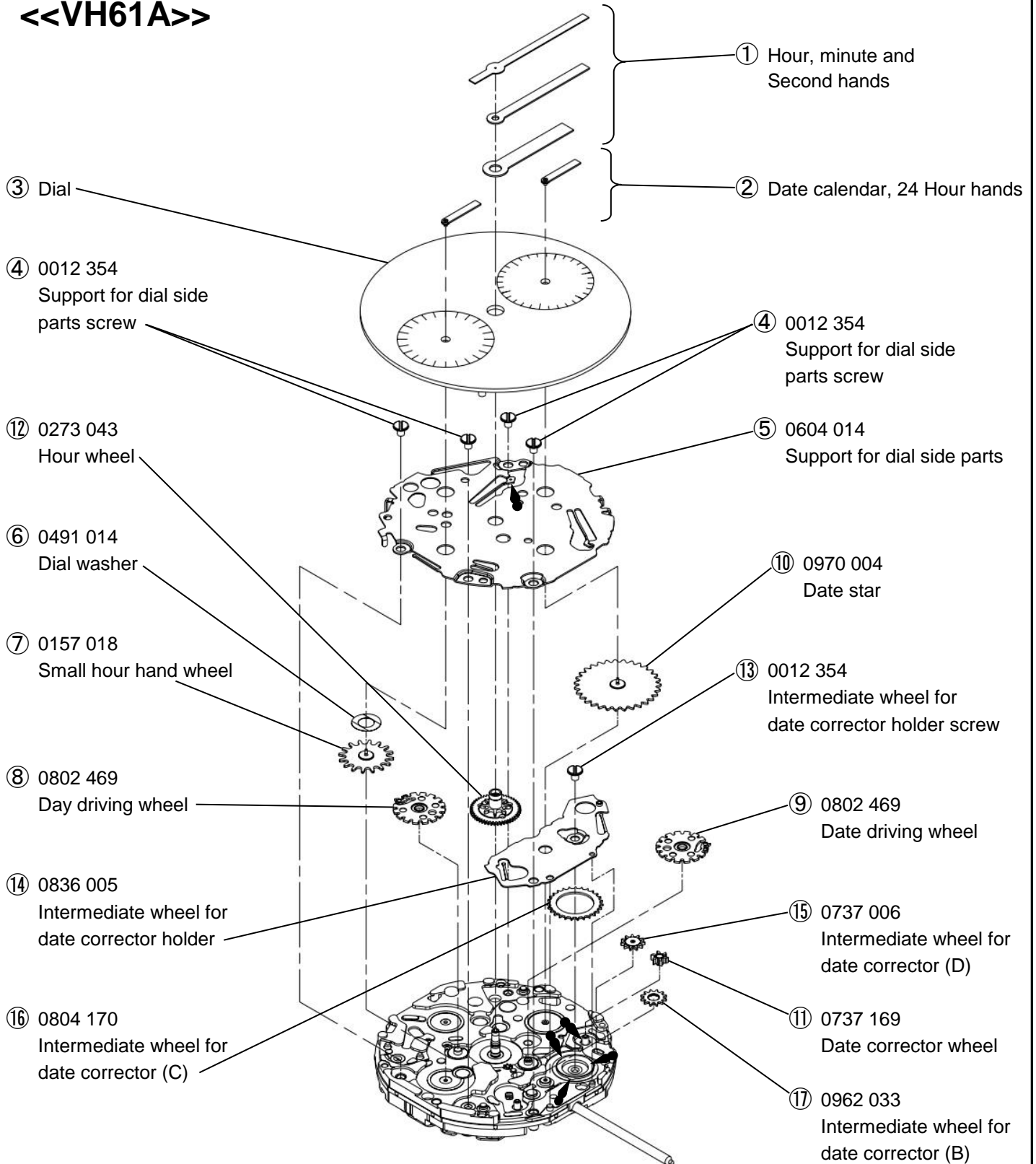

Disassembling procedures Figs. ① → ④⑥	Lubricating : Types of oil	
		A3a / Moebius 9010
Reassembling procedures Figs. ④⑥ → ①		A2a / Moebius 9030
	Oil quantity	
		Normal quantity
		Sufficient quantity

## <<VH61A>>



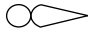
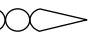

Disassembling procedures Figs. ① → ④⑥	Lubricating : Types of oil	
		A3a / Moebius 9010
Reassembling procedures Figs. ④⑥ → ①		A2a / Moebius 9030
	Oil quantity	 Normal quantity
		Sufficient quantity

## <<VH64A>>

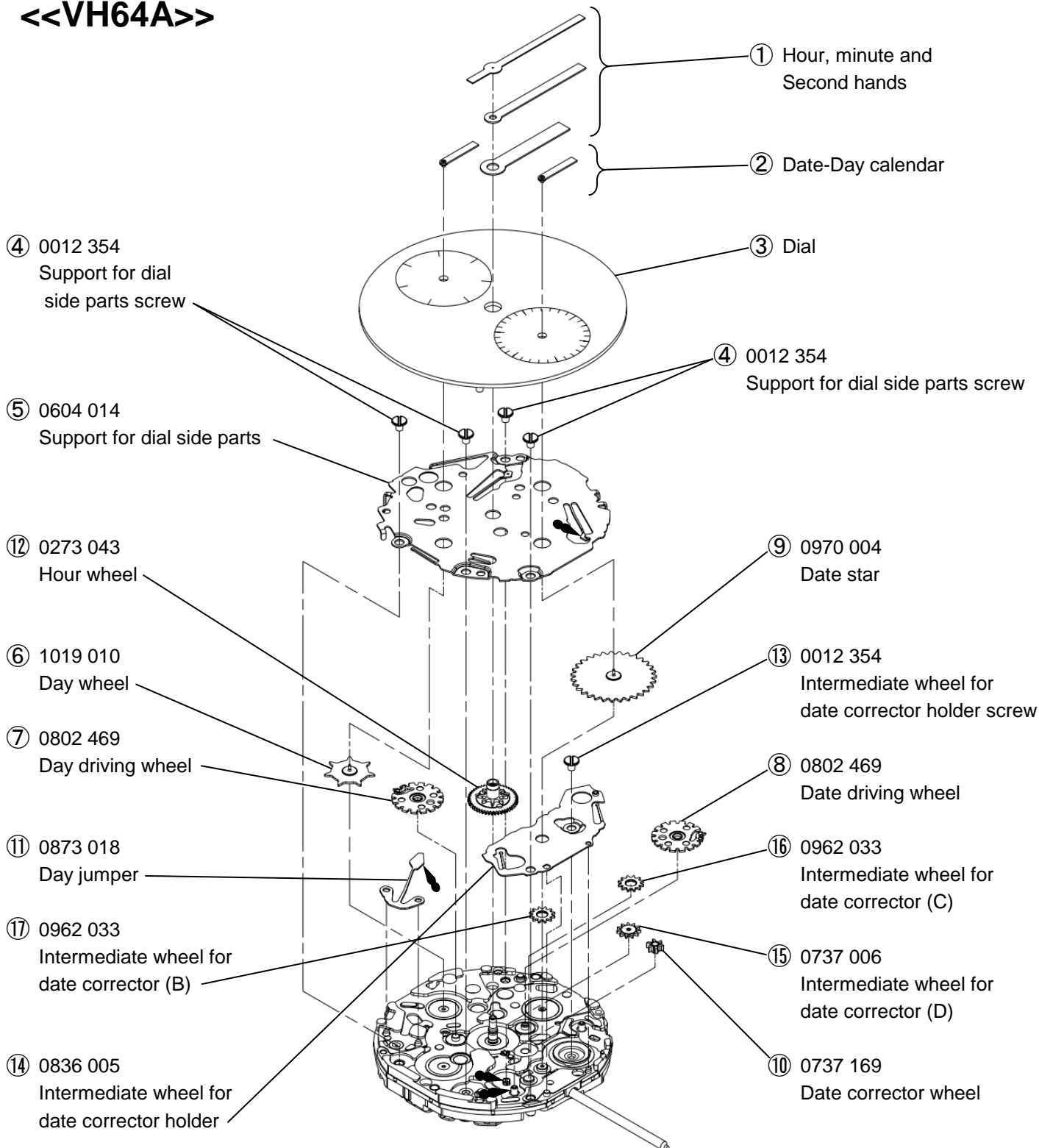

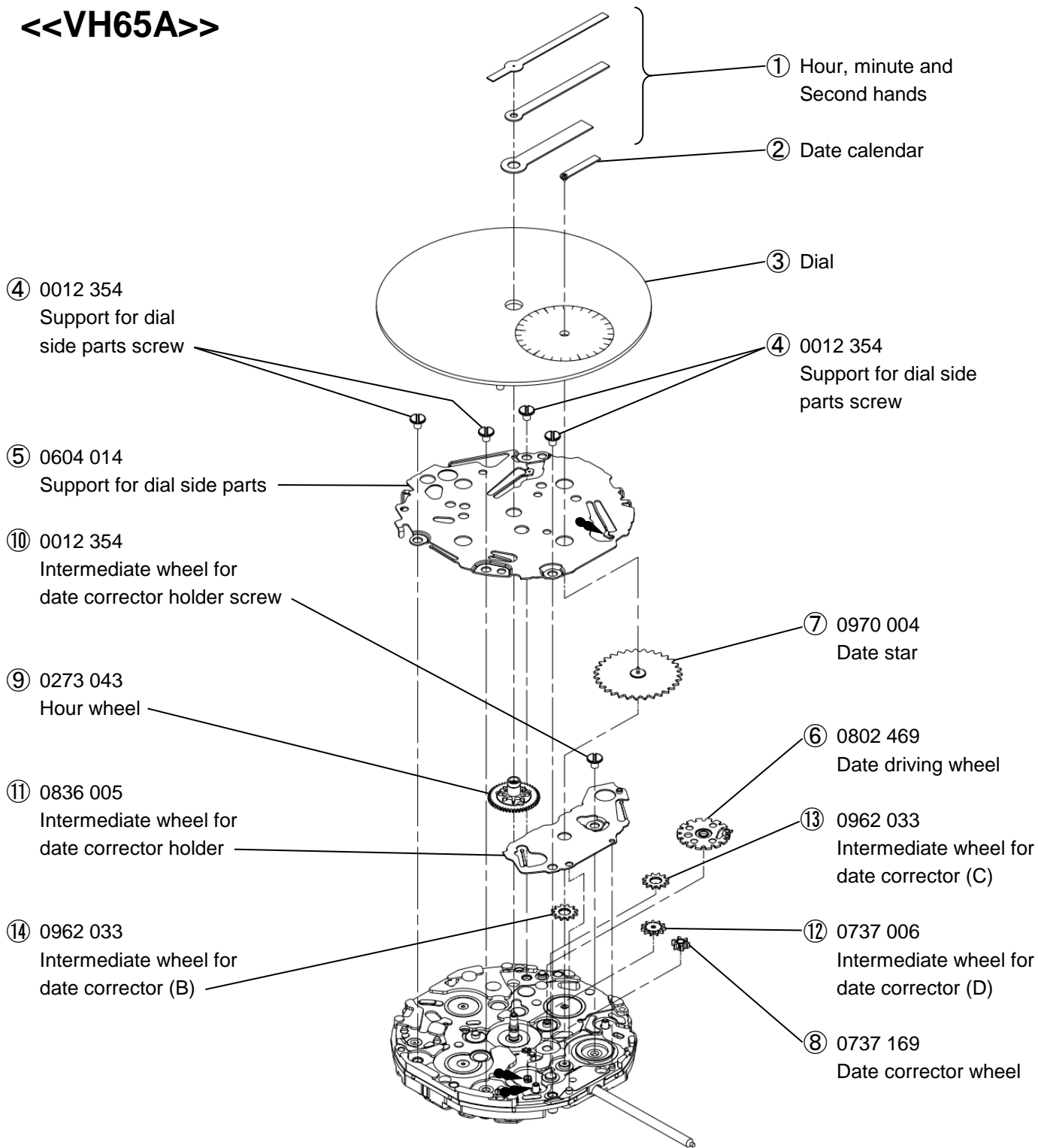

Disassembling procedures Figs. ① → ④⑥	Lubricating : Types of oil	
		A3a / Moebius 9010
Reassembling procedures Figs. ④⑥ → ①		A2a / Moebius 9030
	Oil quantity	
		Normal quantity
		Sufficient quantity

## <<VH65A>>





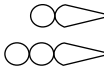

Disassembling procedures Figs. ① → ④⑥	Lubricating : Types of oil	
		A3a / Moebius 9010
Reassembling procedures Figs. ④⑥ → ①		A2a / Moebius 9030
	Oil quantity	
		Normal quantity
		Sufficient quantity

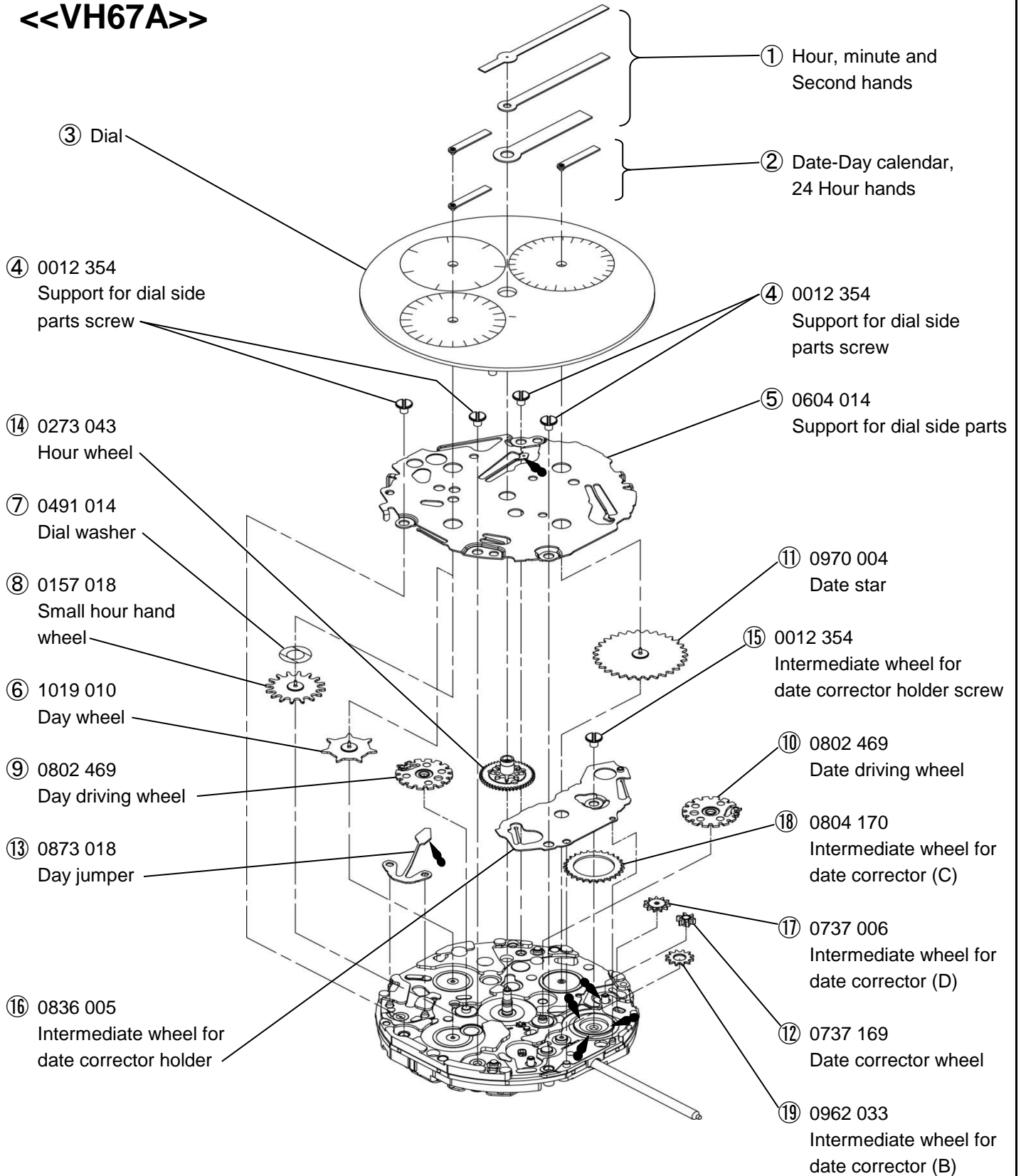



## <<VH67A>>

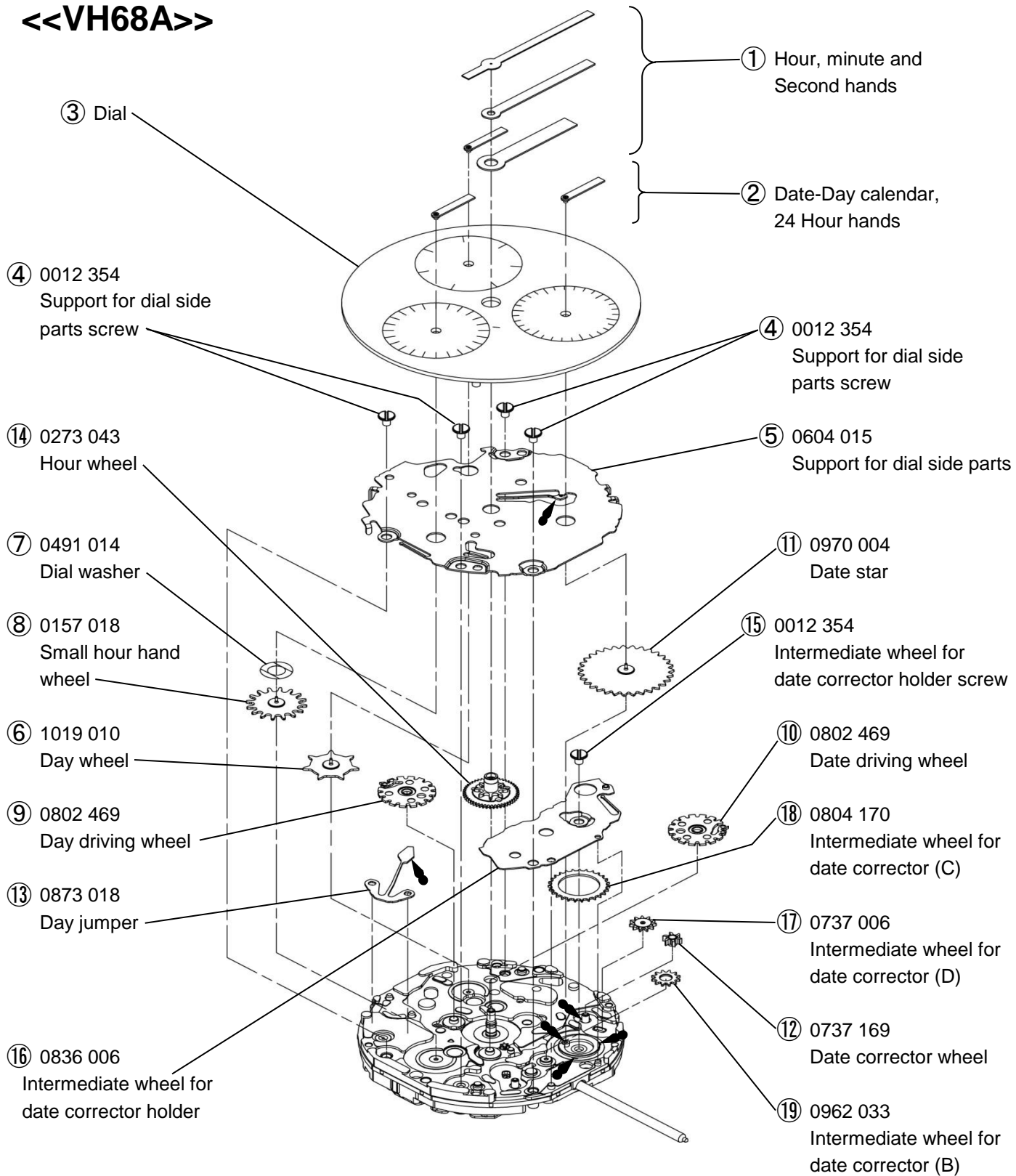

Disassembling procedures Figs. ① → ④⑥	Lubricating : Types of oil  A3a / Moebius 9010  A2a / Moebius 9030
Reassembling procedures Figs. ④⑥ → ①	

## <<VH68A>>

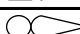

Disassembling procedures Figs. ① → ④⑥	Lubricating : Types of oil		A3a / Moebius 9010
Reassembling procedures Figs. ④⑥ → ①	Oil quantity		A2a / Moebius 9030
			Normal quantity
			Sufficient quantity

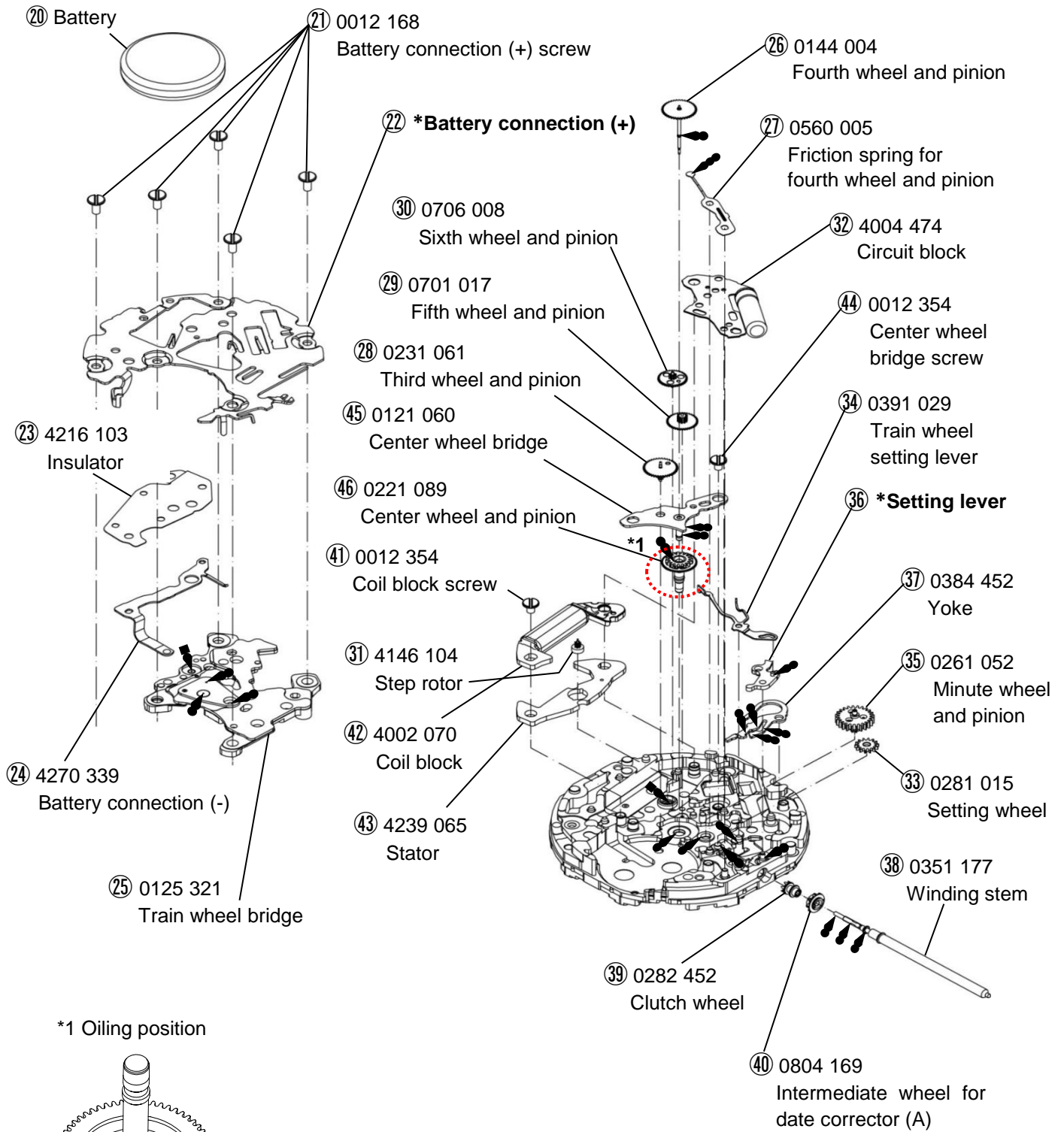

\*Refer to pages 11 for each parts code

Remarks:

O Different parts for each CAL.

Parts name	Parts code	VH60A	VH61A	VH63A	VH64A	VH65A	VH67A	VH68A
② Battery connection (+)	4268 070	—	—	O	—	—	—	—
	4268 072	—	—	—	—	—	—	O
	4268 074	—	—	—	—	—	O	—
	4268 082	—	O	—	—	—	—	—
	4268 084	—	—	—	O	—	—	—
	4268 086	—	—	—	—	O	—	—
	4268 113	O	—	—	—	—	—	—
③ Setting lever	0383 891	—	O	O	O	O	O	O
	0383 154	O	—	—	—	—	—	—

**\* All parts code are subject to change without notice.**

•The explanation here is only for the particular point of Cal.VH60A/VH61A/VH63A/VH64A/VH65A/VH67A/VH68A

## REMARKS ON DISASSEMBLING AND REASSEMBLING

### (1)HAND

•How to install hands:

Place the movement directly on a flat metal plate or such a hard plate when you install the hands.

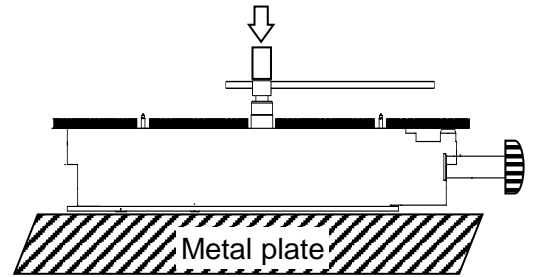

Necessary procedure to setting hands:

- ①Set the dial.
- ②Install the date calendar hand at the 12 o'clock position.
- ③Pull out the crown to the second click position, and change the date by rotating the crown clockwise.
- ④Install the day calendar and 24 hour and hour and minute and second hands at the 12 o'clock position.

### (2)Winding stem

•How to remove:

Pull out the winding stem while pushing the indented portion of the arrow.

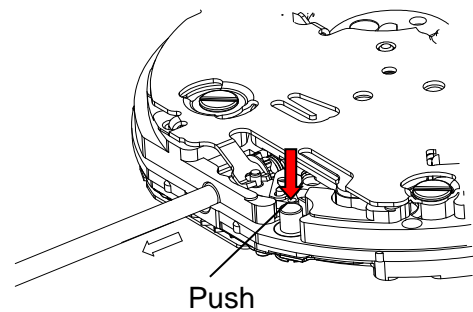

### (3)Battery

•How to install:

Insert the battery in the aslant direction as shown by the arrow. Check the battery connection (+) securely touches the side face of the battery.

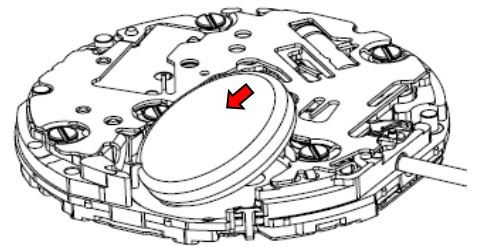

•How to remove:

Firstly slide the battery in the direction of the arrow with tweezers, and then lift the battery.

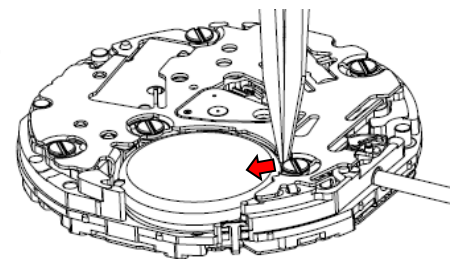

### (4)Insulator

•How to set:

To insulate between the battery connection (+) and the battery connection (-), the insulator should be put at the two pins securely as bellow.

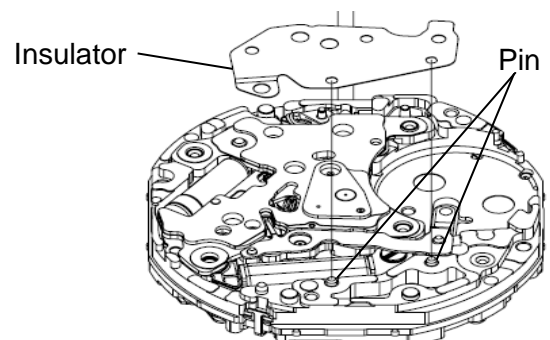

(5) Setting position adjustment (at the time of disassembling and reassembling)

· How to set the Date & Day driving wheels in the correct position:

Note:

Set the indicator finger of a Date & Day driving wheels to the setting position mark on the Main plate.  
An adjustment is unnecessary for VH60A/VH61A/VH65A.

«Cal.VH63/64A setting position»

«Cal.VH67A setting position»

«Cal.VH68A setting position»

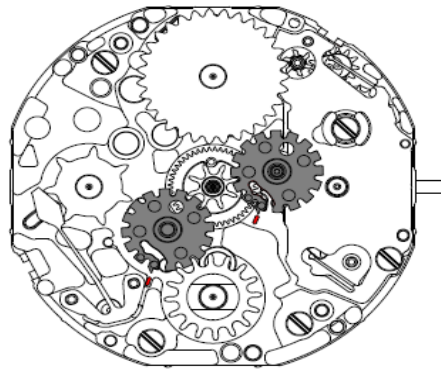
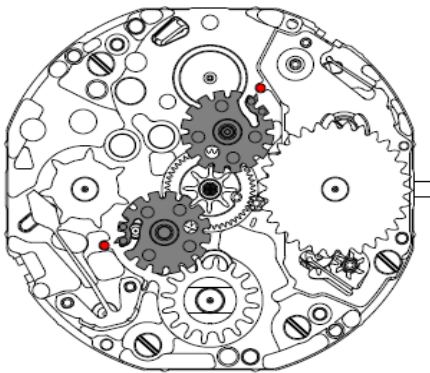

Enlargement

Enlargement

Enlargement

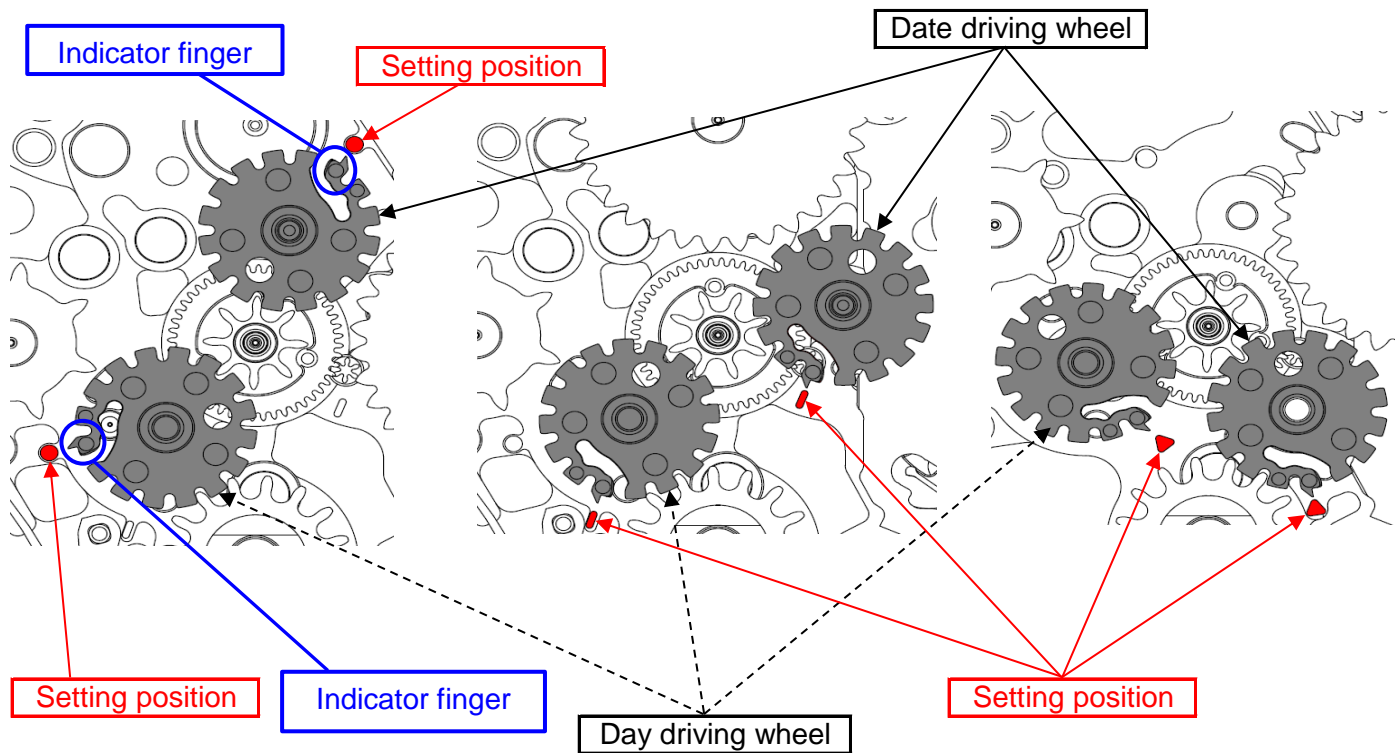

- How to assemble and set the Date & Day jumpers of the support of dial side parts:  
There are two hooks on the support for dial side parts. (Fig.1)  
Assemble the two hooks on the support for dial side parts to the position of the built-in height A of the base plate. (Fig.2)  
Set the Date & Day jumper to the teeth of the Date star & Day wheel.  
Assemble the two hooks on the position of the built-in height B of the base plate. (Fig.3)

example VH63A

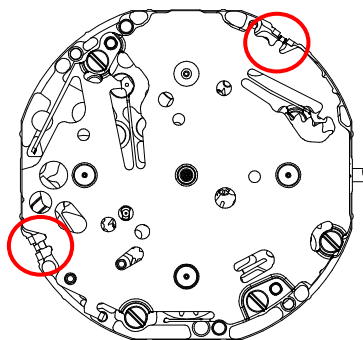

Fig.1 (example VH63A)

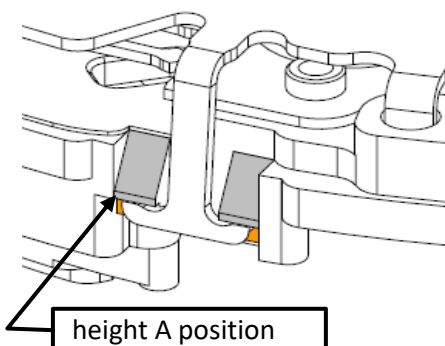

Fig.2 (built-in height A)

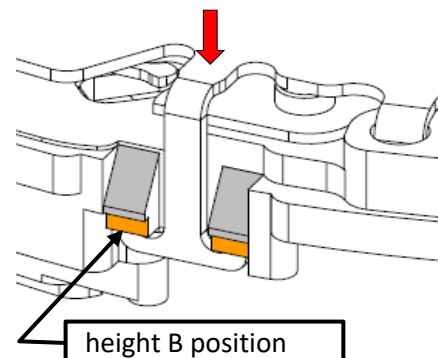
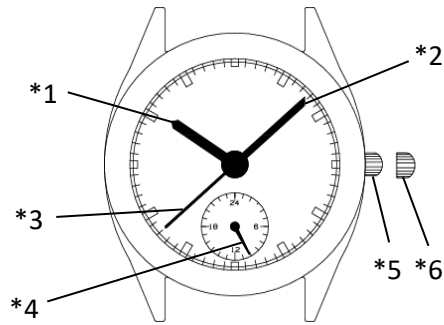

Fig.3 (built-in height B)

## DISPLAY AND CROWN OPERATION

### 《VH60A》



**Note:**

- \*1: Hour hand
- \*2: Minute hand
- \*3: Second hand
- \*4: 24Hour hand
- \*5: Crown at normal position
- \*6: First click
  - Time setting

## TIME SETTING

### 《VH60A》

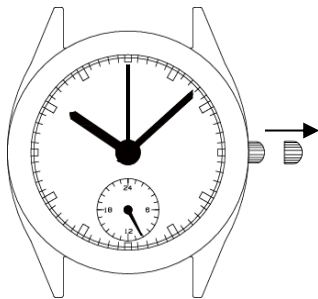

1. pull out the crown to the first click when the second hand is at the 12 O'clock position.

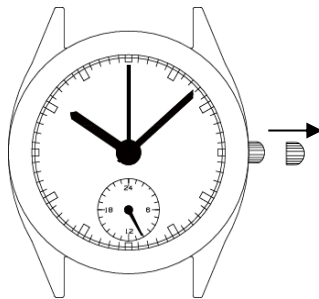

2. Turn the crown to set the hour and minute hands to the time. (Check that AM / PM is set correctly)

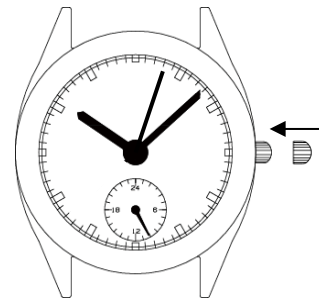

3. Push the crown back in to the normal position in accordance with a time signal.



## DISPLAY AND CROWN OPERATION

《VH61A》

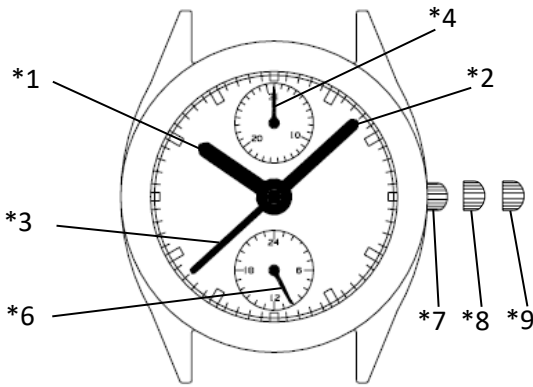

《VH63A》

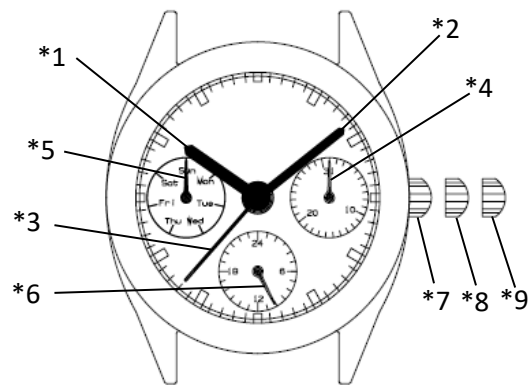

《VH64A》

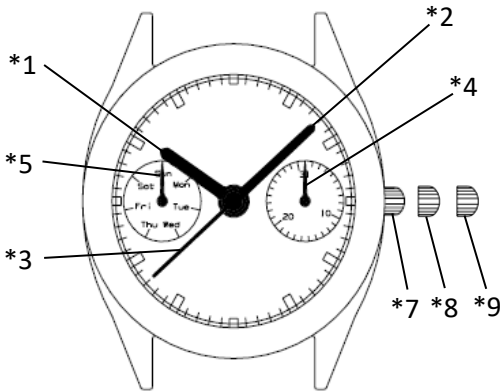

《VH65A》

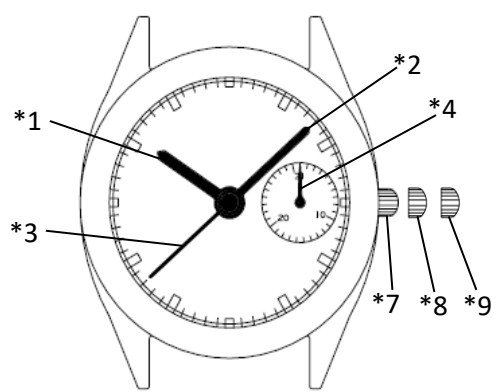

《VH67A》

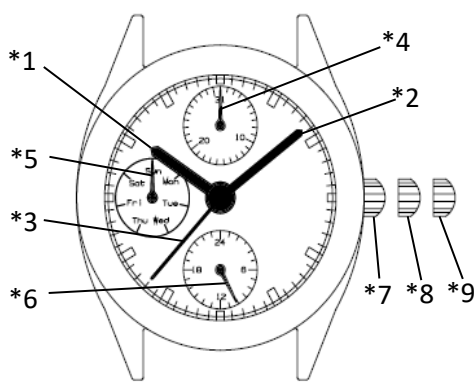

《VH68A》

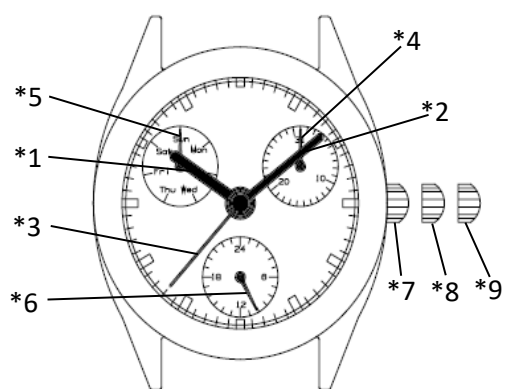

**Note:**

- |                 |                        |  |                  |
|-----------------|------------------------|--|------------------|
| *1: Hour hand   | *4: Date calendar hand | *7: Crown at normal position           | *9: Second click |
| *2: Minute hand | *5: Day calendar hand  | *8: First click                        | • Time setting   |
| *3: Second hand | *6: 24 Hour hand       | • Date setting (Quick change function) |                  |

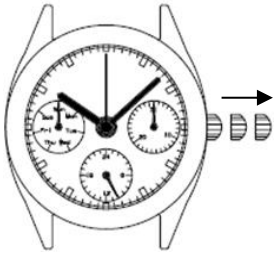
**TIME SETTING**  
《VH61A/VH63A/VH64A/VH65A/VH67A/VH68A》

1.Pull out the crown to the second click when the second hand is at the 12 O'clock position.

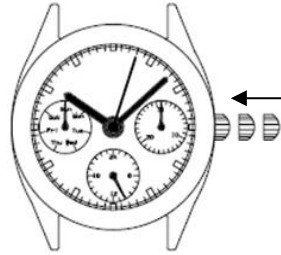

2.Push the crown back into the normal position in signal.

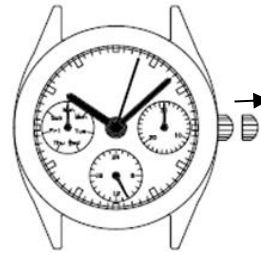

3.Pull out the crown to the first click. Turn the crown counter-clockwise to set the date.

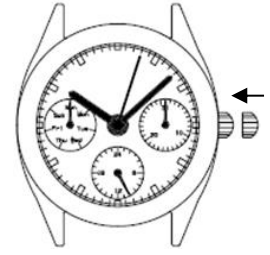

4.Push the crown back into the normal position.

Turn the crown rotation to set the day of the week.

Turn the crown to set the hour and minute hands to the time.  
(Check that AM / PM is set correctly)

\*Do not set the date between 10:00 PM and 2:00 AM

Otherwise, the day may not change properly. If it is necessary to set the date during that time period, first change the time to any time outside it and set the date, and then reset the correct time.